

BLDG	STORY	STUDIO	2-BD	# APT
A	4	32	24	56
B	4	24	24	48
C	4	40	24	64
TTL SITE		96	72	168
240 BEDROOMS				
217 PARKING				

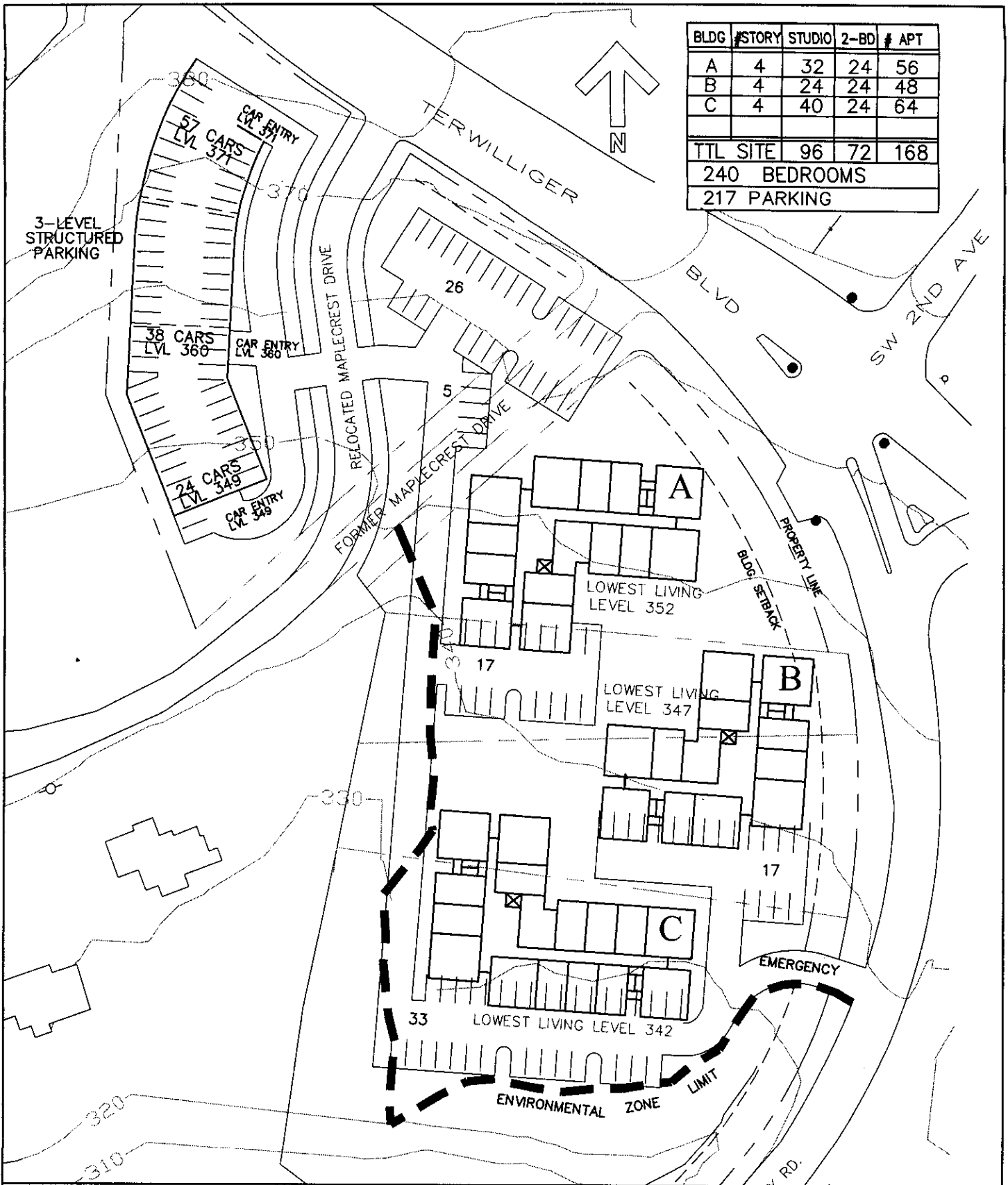

ANDREWS ARCHITECTS
 915 N.E. 25th Ave., Portland, Or 97232
 Tel. (503) 239-4387
 Fax (503) 231-3369

SCHEME 8
 1" = 80'
 4/3/2009

Lewis & Clark College Law Student Housing Study w/ Maplecrest Relocation

for URBAN RESOURCES, Inc.
 Construction Consulting